

**PALLET LIFTER PALLET TRUCK**

- Heavy duty steel construction.
- Pallets with bottom boards must be placed on top of forks.
- 1 year pump warranty.

**Specs**

Part Number:

Model:

Overall Fork WxL:

Fork Width:

Lowered Fork Height:

Raised Fork Height:

Swivel Casters:

Load Wheels:

Weight:

Capacity:

272153

PLFTR

27" x 44"

6 1/2"

3.2"

6" Polyurethane

2" Polyurethane

258 lbs

1,100 lbs

NOTE: ITEM 37N (KIT J)  
DETAILED ON PAGE 2

**REPLACEMENT PARTS LIST**

KIT	ITEM	PART NO.	DESCRIPTION	QTY.
	1		CHAIN WHEEL COVER	1
	2		FLAT WASHER	4
	3		SPRING WASHER	4
	4		SEMICIRCULAR SCREW	4
	5		HEX CAP SCREW	2
	6		WASHER	2
	7	170790	CHAIN WHEEL	2
	8		SPRING COLUMN PIN	1
	9	170791	CHAIN WHEEL SHAFT	1
	10		CHAIN WHEEL HOLDER	1
	11		SET SCREW	2
	12		CHAIN	2
	13		CHAIN SCREW	4
	14		HEX CAP NUT	2
	15		CHAIN SLICE	2
	16		CHAIN PIN	2
A	17		HANDLE	1
A	18		FLAT WASHER	2
A	19		SPRING WASHER	2
A	20		HEX CAP BOLT	2
B	21		FOOT PEDAL COVER	1
B	22		FOOT PEDAL	1
B	23		OIL MOUTH	1
B	24		C-RING	1
B	25		JOINT ROD	1
B	26		STEEL BALL	1
B	27		SPRING	1
B	28		HEX CAP BOLT	1
B	29	170770	FOOT PEDAL HOLDER	1
B	30		OIL MOUTH	1
B	31		C-RING	2
B	32		PRESSURE WHEEL	1
B	33		SHAFT	1
B	34		HEX CAP NUT	1
B	35		JOINT SCREW	1
B	36		OIL MOUTH	1
	37N	272134	CYLINDER	1
C	38		HEX CAP HANDWHEEL	1
C	39		SET SCREW	1
C	40		SET SCREW	1
C	41		SET SITE COVER	2
C	42	170772	TURN SPRING	4
C	43		STRAIGHT ROD	1
C	44		SET SCREW	1

**REPLACEMENT PARTS LIST**

KIT	ITEM	PART NO.	DESCRIPTION	QTY.
C	45		GIMBAL	1
E	46		FLAT WASHER	1
E	47		HEX CAP NUT	1
E	48		FLAT WASHER	1
E	49		SPRING	1
E	50		NUT	4
E	51		BEARING	2
E	52		COVER	2
E	53		TAPER BEARING	2
D	54		SHAFT	1
D	55		BRAKE FOOT PEDAL	1
D	56		BUSHING	1
D	57		SET SCREW	2
D	58		BRAKE CAM	1
	59		SEMICIRCULAR SCREW	2
	60		SPRING WASHER	2
	61		FLAT WASHER	2
	62		PROTECT COVER	2
E	63		BIG WHEEL	2
E	64		BEARING	4
E	65		DUST COVER	4
E	66		SHAFT	2
E	67		C-RING	2
E	68		WHEEL HOLDER	2
E	69		BRAKE ROD	1
	70		FRAME SEAT	1
G	71		C-RING	4
G	72		BEARING	4
G	73		SHAFT	2
G	74		SMALL SHAFT	2
	75		FORK	1
F	76		C-RING	2
F	77		BEARING	2
F	78		UP GUIDE ROLLER	1
F	79		LINK ASSEMBLY	2
F	80		OIL MOUTH	2
F	81		SHAFT	2
F	82		SPRING COLUMN PIN	2
F	83		C-RING	2
F	84		BEARING	2
F	85		DOWN GUIDE ROLLER	2
F	86		OIL MOUTH	2
F	87		SPRING COLUMN PIN	2
F	88		SHAFT	2

**REPLACEMENT KITS LIST**

KIT	PART NO.	DESCRIPTION	QTY.
A	170763	HANDLE ASSEMBLY (INCLUDES ITEMS 17-20)	1
B	170764	FOOT PEDAL ASSEMBLY (INCLUDES ITEMS 21-36)	1
C	170765	OPERATION ROD ASSEMBLY (INCLUDES ITEMS 38-45)	1
D	170766	BRAKE PEDAL ASSEMBLY (INCLUDES ITEMS 54-58)	1
*E	170767	BACK WHEEL ASSEMBLY [STEM MOUNTED] (INCLUDES ITEMS 46-53 & 63-69)	1
	170781	BACK WHEEL ASSEMBLY [PLATE MOUNTED] (INCLUDES ITEMS 46-53 & 63-69)	1
F	170768	LINK ASSEMBLY (INCLUDES ITEMS 76-88)	1
G	170769	FRONT WHEEL ASSEMBLY (INCLUDES ITEMS 71-74)	1
H	170780	SEAL KIT (INCLUDES ITEMS 2C, 3C, 4C, 7C, 9C, 15C, 22C, 23C, 27C, 28C, 31C, 33C, 34C & 38C)	1
J	272134	COMPLETE REPLACEMENT HYDRAULIC PUMP (INCLUDES ITEMS 1C-38C)	1

\*KIT E BACK WHEEL ASSEMBLY HAS TWO DIFFERENT STYLES FOR DIFFERENT VERSIONS:  
P/N 170767 BACK WHEEL ASSEMBLY (STEM MOUNTED) OLD STYLE.  
P/N 170781 BACK WHEEL ASSEMBLY (PLATE MOUNTED) NEW STYLE.

PRINT ISSUED

JUNE 24, 2015

WESCO MANUFACTURING  
ENGINEERING DEPARTMENT

WESCO INDUSTRIAL PRODUCTS INC.

NORTH WALES PENNA. 19454

REV. 0000 Hydraulic Pallet Lifter

27 x 44

REVISED (PLEASE CHANGE SPECIFIED)

REVISED (PLEASE CHANGE SPECIFIED)

REVISED (PLEASE CHANGE SPECIFIED)

REVISED (PLEASE CHANGE SPECIFIED)

REVISED (PLEASE CHANGE SPECIFIED)

D-272153

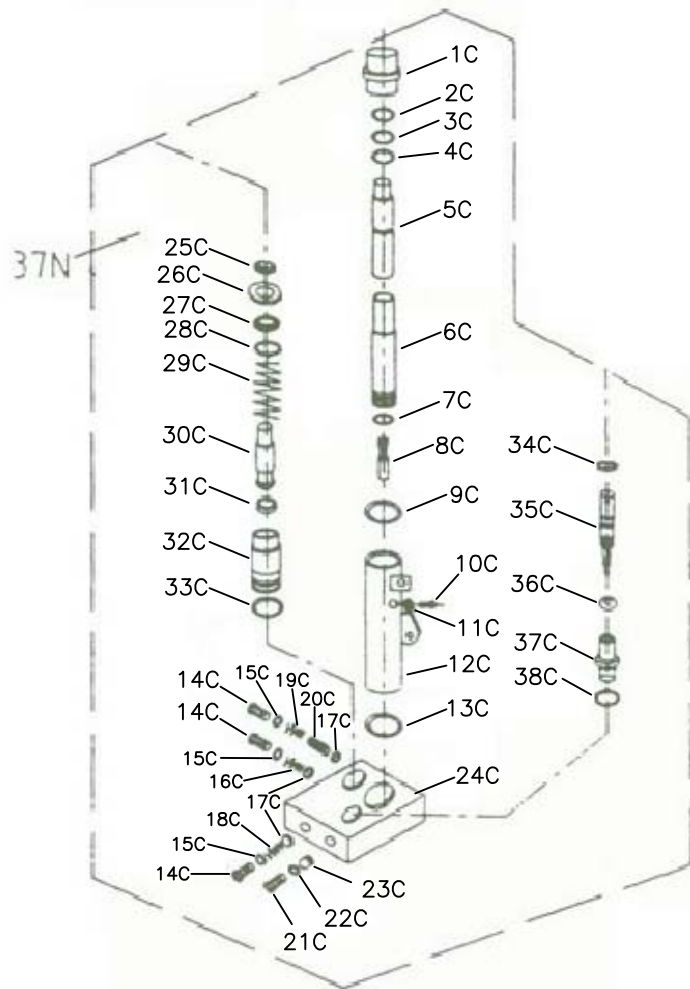

REPLACEMENT PARTS LIST				
KIT	ITEM	PART NO.	DESCRIPTION	QTY.
	37N	272134	CYLINDER	1
J	1C		TOP NUT	1
J,H	2C		DUST COVER	1
J,H	3C		O-RING	1
J,H	4C		OIL SEAL	1
J	5C		LIFT PISTON	1
J	6C		BODY CYLINDER	1
J,H	7C		WASHER	1
J	8C		FILTER	1
J,H	9C		WASHER	1
J	10C		HEX CAP PLUG	1
J	11C		O-RING	1
J	12C		BODY CYLINDER	1
J	13C		WASHER	1
J	14C		HEX CAP PLUG	1
J,H	15C		O-RING	1
J	16C		SPRING	1
J	17C		STEEL BALL	1
J	18C		SPRING	1
J	19C		SPRING	1

REPLACEMENT PARTS LIST				
KIT	ITEM	PART NO.	DESCRIPTION	QTY.
J	20C		PIN	1
J	21C		HEX CAP PLUG	1
J,H	22C		O-RING	1
J,H	23C	170771	LOWERING VALVE	1
J	24C		VALVE	1
J	25C		C-RING	1
J	26C		SPRING SEAT	1
J,H	27C		DUST COVER	1
J,H	28C		O-RING	1
J	29C		SPRING	1
J	30C		LIFT PISTON	1
J,H	31C		OIL SEAL	1
J	32C		PUMP CYLINDER	1
J,H	33C		O-RING	1
J,H	34C		O-RING	1
J	35C		PLUG	1
J	36C		STEEL BALL	1
J	37C		CLOSE SCREW COVER	1
J,H	38C		O-RING	1

REPLACEMENT KITS LIST			
KIT	PART NO.	DESCRIPTION	QTY.
H	170780	SEAL KIT (INCLUDES ITEMS 2C, 3C, 4C, 7C, 9C, 15C, 22C, 23C, 27C, 28C, 31C, 33C, 34C & 38C)	1
J	272134	COMPLETE REPLACEMENT HYDRAULIC PUMP #37N (INCLUDES COMPLETE ITEM 37N ITEMS 1C-38C)	1

PRINT ISSUED

JUNE 24, 2015

WESCO MANUFACTURING  
ENGINEERING DEPARTMENT

WESCO INDUSTRIAL PRODUCTS INC.		PENNA. 19454	
NORTH WALES		RWS 06-24-15	
PART NAME	Hydraulic Pallet Lifter	DATE	
SIZE	27 x 44	APP. ENG.	
TOLERANCES UNLESS OTHERWISE SPECIFIED			
FRACTIONS	3 PLACES DECIMAL	3 PLACES DECIMAL	NONE
AS SHOWN	0.001	0.01	
ANGLES & 1-1/2"	1 SHEET	OF 2	D-272153
DRAW ALL SHARP EDGES AND BREAK ALL DIMS			